

## Product Configuration Technical Specification Sheet

# Hyponic®

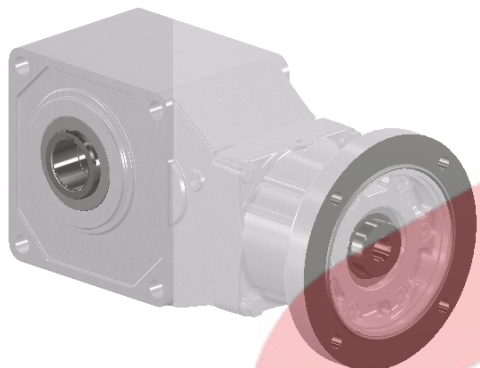

Basic Product Information	
Model Number	RNYX-1420Y-40
Hyponic Frame Size	1420
Housing Style	(Y) Hollow Shaft
Output Shaft Orientation	(N) Universal
Output Shaft	Keyed Hollow Bore: Ø 1-3/8 in
Input Configuration	(X) Hollow Input Shaft - NEMA C-Face

Configuration Rating Information	
Nominal Ratio	40
Input / Output RPM	1750 / 43.8

*NOTE: Information displayed on this technical specification sheet will vary, as it is based upon your actual selections. Please see next page for more configuration specific information.*

Dimensions shown are for reference only and are subject to change without notice, unless certified. Certified prints are available after receipt of an order; consult factory for more information. Image shown is representative and may not reflect actual unit and/or orientation.

## Quiet, Compact and Maintenance-Free

All-steel hypoid gear design transmits torque more efficiently for more torque density in a compact unit

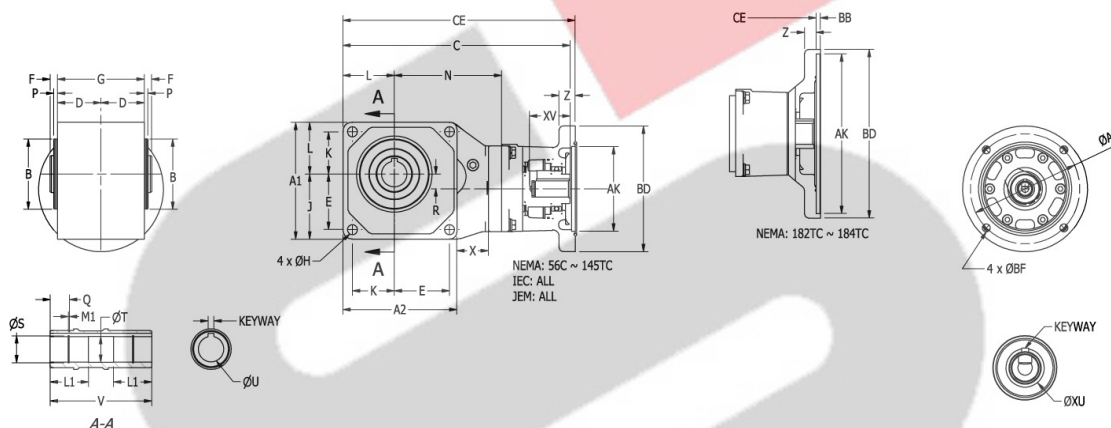

Units: inch Approx. Weight 28 lb

Casing	A1	A2	B	B TOL		D	E	F	G	H	J	K	L	N	P	R	X
	6.22	6.10	3.7402	0 / -0.0014		2.32	2.95	0.39	4.65	0.55	3.46	2.24	2.76	5.75	0.20	0.79	1.69
Keyed Hollow Bore	U	U TOL			V	S	L1	Q	M1	T	KEYWAY						
	1.3750	+0.0015 / +0.0006			5.43	1.46	2.05	1.0236	0.0559	1.40	0.31						
Hollow Shaft Adapter	CE	C	AK	BD	AJ	BF	Z	BB	XU	XU TOL			XV	KEYWAY			
	12.44	12.13	4.50	6.69	5.87	0.43	0.87	-	0.6250	+0.0015 / +0.0008			2.01	3/16 x 3/32			

## Product Configuration Technical Specification Sheet

Input Configuration		Product Ratings	
Input Stage Frame Size	GN131C (30K) - Size 30, Hypoid Ratio 10:1	Application or Motor Input Power	- HP
Motor Standard	NEMA	Service Factor	-
Motor Frame Size	56C	Calculated Output Torque	- in-lbs
Motor Mounting	No	Rated Input RPM	1750
Motor Coupling Guard	Not Applicable	Rated Output RPM	43.8
Input Shaft Accessory Mounting	Not Applicable	Product Rated Input Power	1.07 HP
		Product Rated Output Torque	1310 in-lbs
		Product Overhung Load Capacity	859 lbf
		Actual Reduction Ratio	60/6*63/16 = 39.3750
Lubrication Specifications		Reducer Options	
Selected Lubrication	Standard Lubrication	Safety Cover	Included
Lubrication Method	Grease	Chemical Duty	Option Not Selected
Lubrication Option	Standard Grease	Food & Washdown Options	None Selected
		Seal Options	Nitrile Seal
		Paint Specification	Silver Powder Coat
Environmental Specifications			
Installation Location	Indoor		
Ambient Temperature	14° - 104°F (-10° - 40°C )		
Ambient Humidity	Under 90%		
Environment	Standard		
Food Grade Required	No		
Elevation Above Sea Level	Under 3300 ft/1000 m		
Configuration Messages			
<b>Recommended Driven Shaft Tolerance - Keyed Hollow Bore</b> Recommended dimensional tolerance of the driven shaft is as follows: For uniform load - ISO/JIS/DIN h6 or js6 For shock load, or significant radial load - ISO/JIS/DIN js6 or k6			

All Configuration data contained within this technical specification sheet is subject to change. Please refer to Sumitomo Drive Technologies' Terms and Conditions located at [smcyclo.com](http://smcyclo.com) for further information. For more specific product and/or application data, please contact your Sumitomo Drive Technologies' Representative.

To request a catalog, or for more information, on any of our high quality products, please visit our website: [www.sumitomodrive.com](http://www.sumitomodrive.com).

*Thank you for your interest in Sumitomo products.*